

# 1591XXDSFL Enclosure

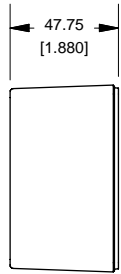

**SIDE VIEW OF BOX**

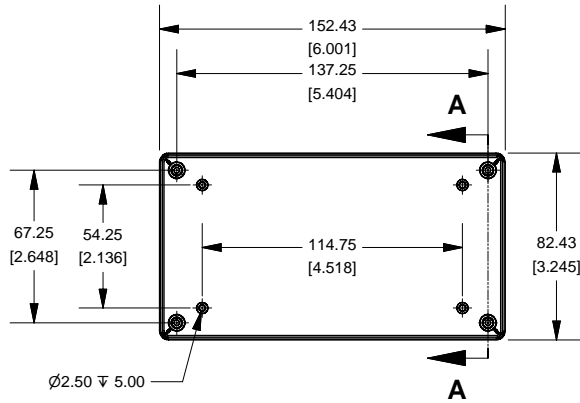

**TOP VIEW OF BOX**

AVERAGE WALL THICKNES  
2.00  
[.079]

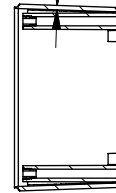

**SECTION A-A**

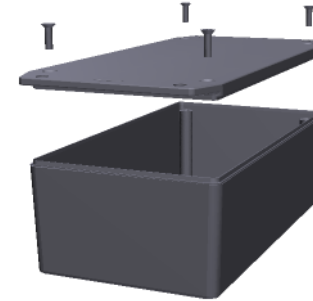

Cover Screws #4 x 1/2" Self-Tapping Screws

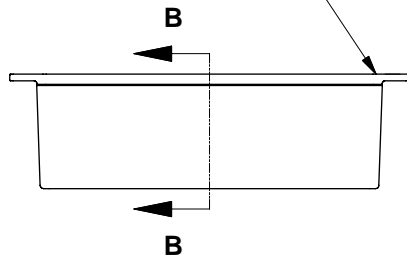

**SIDE VIEW OF ENCLOSURE**

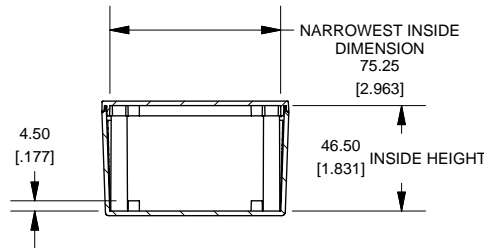

**SECTION B-B**

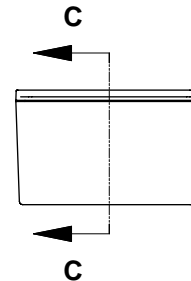

**END VIEW OF ENCLOSURE**

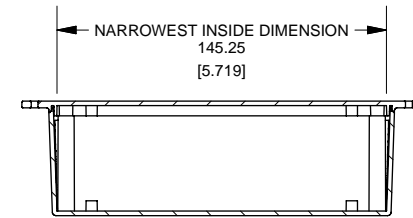

**SECTION C-C**

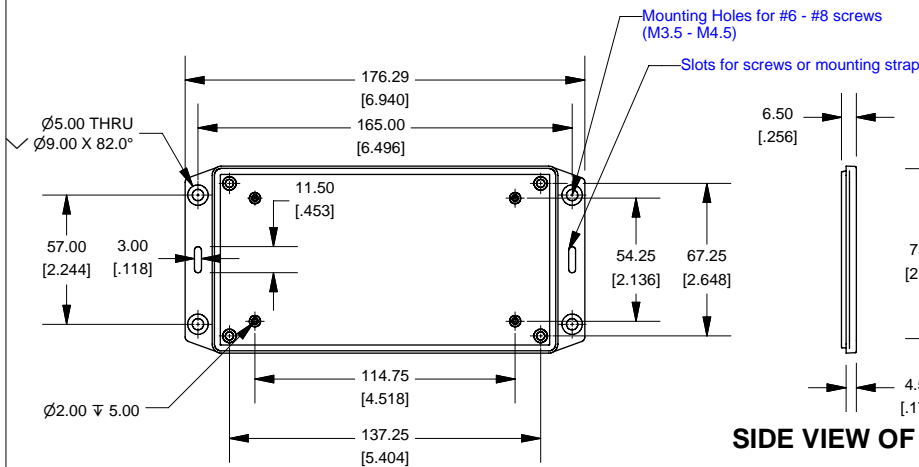

**BOTTOM VIEW OF LID**

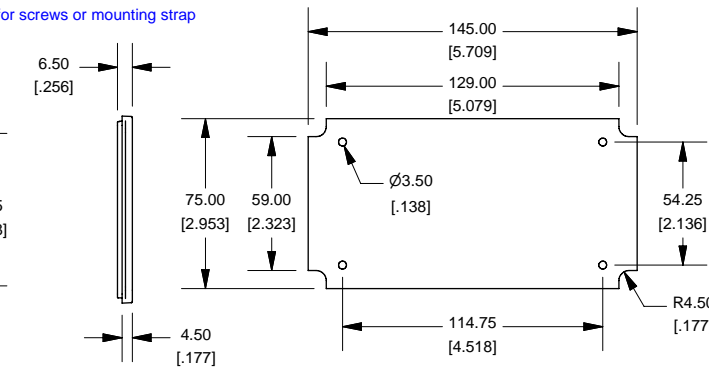

**SIDE VIEW OF LID**

Max Size PCB. Fits in Box or in Lid.  
Not supplied with Enclosure

**Note:**

Enclosures can be Factory Modified ( Milling, Drilling, Printing etc. )  
Solid models of this enclosure available in STEP or IGES.  
Contact Factory [mjm@hammondmfg.com](mailto:mjm@hammondmfg.com)

NOTE	
Enclosure molded from GPABS UL-94HB plastic	
Other materials / colours available. Consult factory.	

1591XXDSFL	
1591XXDSFL Enclosure	
Black - RAL 7011	1591XXDSFLBK
ACCESSORIES	
Black Cover Screws	1591TS100BK
PCB Screws	1593ATS50 (pkg 50)
[ #4 x 1/4" self-tapping (6.4mm) ]	1593ATS100 (pkg 100)

